

DRYLINING BRACKET (EVGL2/ EVGL9)



Fire Rated to EN 1363

Application Guide

- Use Evolution Standard Drylining Bracket (EVGL2) for cavity width 25 to 60mm.
- Use Evolution Extended Drylining Bracket (EVGL9) for cavity widths 25 to 130mm.
- Fix Dryliner Track at 600mm centres to the floor and structural soffit. Make sure to allow for required cavity width. When applying the track directly to new concrete ensure the concrete is dry. We recommend you also use damp proofing membrane.
- Mark horizontal lines at 800mm centres and then mark vertical lines at 600mm maximum centres (400mm for thermal laminates) on the wall to locate Evolution Drylining Brackets. Mark lines as close as possible to corners.
- Position Evolution Drylining Brackets directly to wall at maximum 800mm vertical centres on marked lines. Suitable fixings should be used (see table below) and care must be taken not to damage the stiffening ribs. Fold up legs and secure to wall with appropriate fixing through horizontal slot.
- Ensure channel is plumb and secure to bracket by fixing each leg of bracket to the channel using an Evolution Wafer Head Screw (see ref.1). The slotted centre holes allow adjustment by loosening the screw, repositioning the Dryliner Channel and re-tightening the screw. Where needed, bend back the legs of the bracket so it does not stick out past the face of the channel.



Evolution Drylining Brackets (EVGL2/ EVGL9)

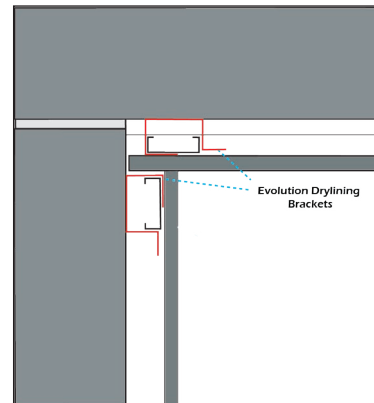

Ref.1 (WHS DZ12)

BASE MATERIAL	FIXING TYPE	PICTURE
STEEL (1.5-3.5mm)	TSPH5.5-25-3	
STEEL (4.0 - 12.0mm)	TSLP5.5-38-5	
BRICK/ BLOCK	MN640 MSHH6.3-32-516	
CONCRETE	MN640 MSHH6.3-32-516	

